

Aluminium through connectors with partition 16 -
1200 mm²

AS300SOLID

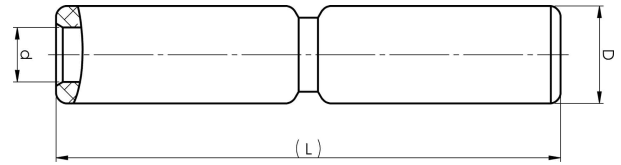

- Used primarily for splicing two Al conductors with the same area.
- Two plus two crimps are needed.
- With partition.

Al through connector with partition for solid Al cable
300 mm². Used with Elpress certified system V250.



Item number: **7313-401600**

EAN: **7393487020610**

d (mm): **20**

D (mm): **36**

L (mm): **177**

s (mm) - strip length: **83**

AWG/MCM Solid Al: **600**

mm² Solid Al: **300**