

Shearbolt terminals 10 - 630 mm<sup>2</sup> (reversible screw)

# SL150R95S- 12X2-40

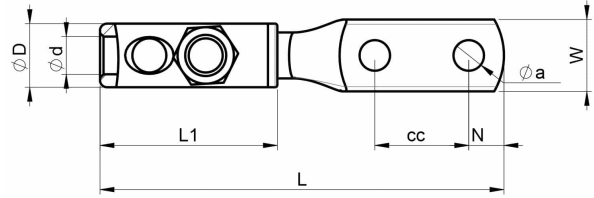

- shearbolt material: brass for minimum friction
- reversible shear-off shearbolts
- voltage range 1-36 kV
- meets the requirements of IEC standard 61238-1:2003
- the terminals are of the bimetallic type for best functionality

Shearbolt terminal 1-36 kV that is suitable for both Al and Cu class 1 and class 2 cable, with two M12 holes in the palm. Round cable 95-150 mm<sup>2</sup>, sector shaped cable 95 mm<sup>2</sup>.



Item number: **7334-015900**

EAN: **7393487079687**

a (mm): **12**

W (mm): **30.5**

N (mm): **15**

cc (mm): **40**

d (mm): **16**

D (mm): **27**

L1 (mm): **75.5**

L (mm): **172**

t (mm) - palm thickness: **6.3**

s (mm) - strip length: **76**

Screw: **M12x2**

Max voltage (kV): **1-36**

Screen conductor (mm<sup>2</sup>): **70-95**

Cable type Round (mm<sup>2</sup>): **95-150**

Cable type Sector (mm<sup>2</sup>): **95**