

Pre-insulated end terminals 0.14 - 120 mm<sup>2</sup> ET,  
standard colour

# A2,5-12ET

- Material: Cu 99.95%, tin plated Cu/Sn, CSA approved.
- Polypropylene insulation, colour code W.

Pre-insulated end terminal ET, 2.5 mm<sup>2</sup>. Used with certified tool PEB0110T.

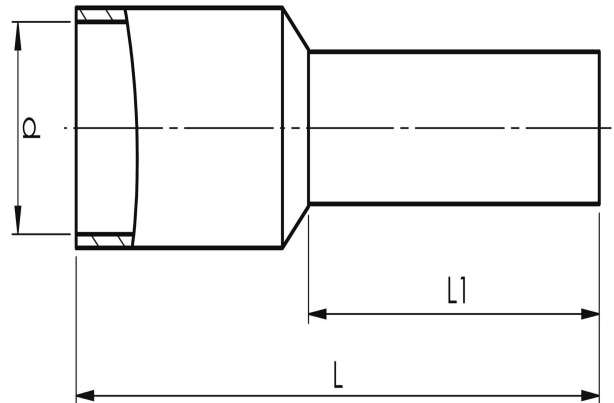
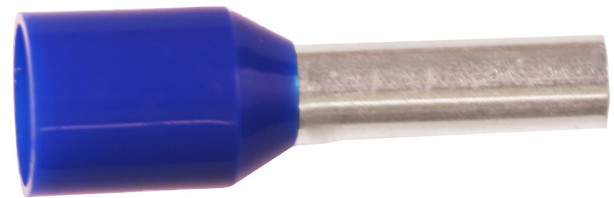

Item number: **7287-006000**

EAN: **7393487012974**

d (mm): **4.2**

L1 (mm): **12**

L (mm): **19**

s (mm) - strip length: **14**

Working temperature, Min (°C): **-40**

Working temperature, Max (°C): **40**

Insulation material: **PP**

Insulation colour: **Blue (end sleeves)**

Material: **Cu, Cu/Sn**

Measures acc DIN46228: **Yes**

AWG/MCM Cu: **14 AWG**

mm<sup>2</sup> Cu: **2,5**